

# FLUOROCARBON LININGS

## DIP PIPES

Steel fabrications using forged flanges  
low carbon tube and boiler plate  
and PTFE seamless extrusions to ASTM D  
1457 type III

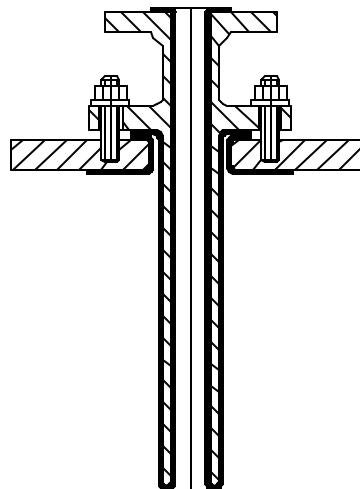

## Continuous and Welded types

Sizes 1 - 4in NB (25 - 100)  
Max. length 120in (3000mm)  
Straight or Curved  
Flanged as required  
Tips available as shown

## Continuous Type

This type is made by inserting extruded thick wall PTFE tube into a steel fabrication, providing a continuous, weld-free lining inside and out.

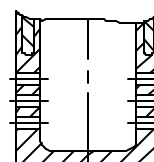

## Welded Type

Welded types are particularly suitable for curved, and extended dip pipes, spargers and tipped types such as thermowells.

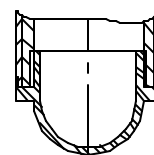

Pressure rating 150 psig (10 bar)  
Vacuum Rating 1 - 6in 200<sup>0</sup> C  
Service temperature -30<sup>0</sup> C to +200<sup>0</sup> C

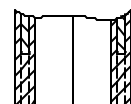

Loose pipe flanges are available.  
Nozzle flange adaptors cover all  
sizes and styles of tank flanges.

